

IMPORTANT: READ BEFORE USING  
ANY QUESTIONS? TURTLEBEACH.COM/SUPPORT  
IMPORTANT À LIRE AVANT UTILISATION  
DES QUESTIONS? TURTLEBEACH.COM/SUPPORT

# QUICK-START GUIDE GUIDE DE DÉMARRAGE RAPIDE



## Declaration of Conformity

Marking by this symbol: 

indicates compliance with the Essential Requirements of the EMC Directive of the European Union (2014/30/EU).

Please visit the following URL for a complete copy of the Declaration of Conformity:  
<http://www.turtlebeach.com/homologation>



This symbol on the product or its packaging indicates that this product must not be disposed of with your other household waste. Instead, it is your responsibility to dispose of your waste equipment by handing it over to a designated collection point for the recycling of waste electrical and electronic equipment. The separate collection and recycling of your waste equipment at the time of disposal will help conserve natural resources and ensure that it is recycled in a manner that protects human health and the environment. For more information about where you can drop off your waste for recycling, please contact your local authority, or where you purchased your product.

Voyetra Turtle Beach Inc. is obligated as a producer with a main activity of selling under The Producer Responsibility Obligations (Packaging Waste) Regulations 2007. To fulfil our obligation we are registered with Comply Direct and their Recycling Room. Here you will find advice and information on packaging waste management, recycling symbols and the waste hierarchy principles of reduce, reuse and recycle. <https://www.complydirect.com/the-recycling-room/>



# CONTENTS | CONTENU

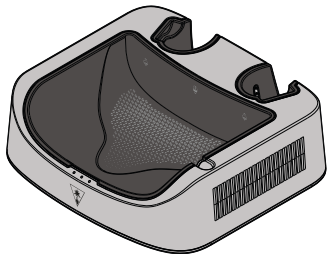

**A** VR CHARGE STATION  
STATION DE CHARGE VR

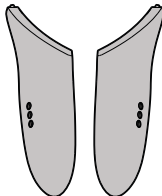

**B** CONTROLLER BATTERY DOORS  
COUVERCLES DE BATTERIE  
POUR MANETTE



**C** MAGNETIC USB-C  
CONNECTOR  
CONNECTEUR  
MAGNÉTIQUE USB-C



**D** RECHARGEABLE  
BATTERY PACK X2  
LOT DE BATTERIES  
RECHARGEABLES X2

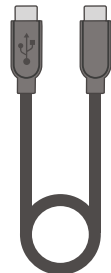

**E** 6.5/2 M USB-C TO  
USB-C CABLE  
CÂBLE USB-C À  
USB-C DE 2 M

# SETUP INSTRUCTIONS | INSTRUCTIONS DE CONFIGURATION

\* Meta Quest 2 Controllers and headset not included  
\* Manettes et casque Meta Quest 2 non fournis

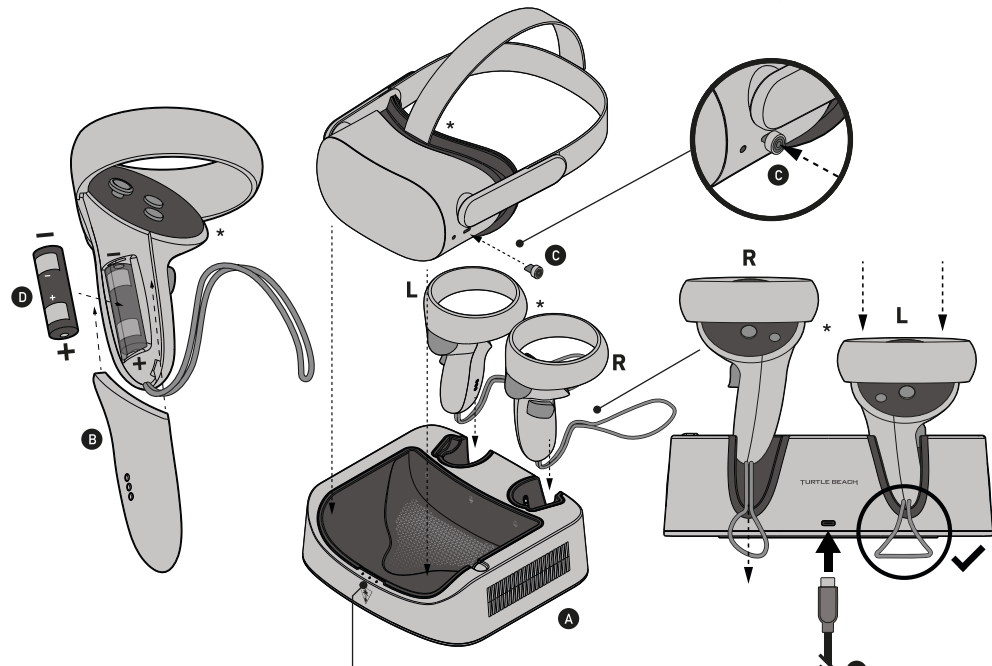

	AMBER = CHARGING AMBRE = EN CHARGE
	GREEN = CHARGED VERT = ENTIÈREMENT CHARGÉES

Connect to Quest 2 power supply  
(not included)  
Connectez-vous à l'alimentation  
électrique Quest 2 (non incluse)

